



VIDEO TECHNOLOGIES

Instructions for pairing a remote control to your EPIC Slate set-top box:

Ensure that your EPIC Slate remote has two triple A batteries

Press and Hold 'Home' and 'OK' buttons simultaneously for 3 seconds to pair remote

After three seconds, you should see a flashing red light at the top of your remote

Test your remote to see if your box responds to its input

If pairing fails, please contact your service provider

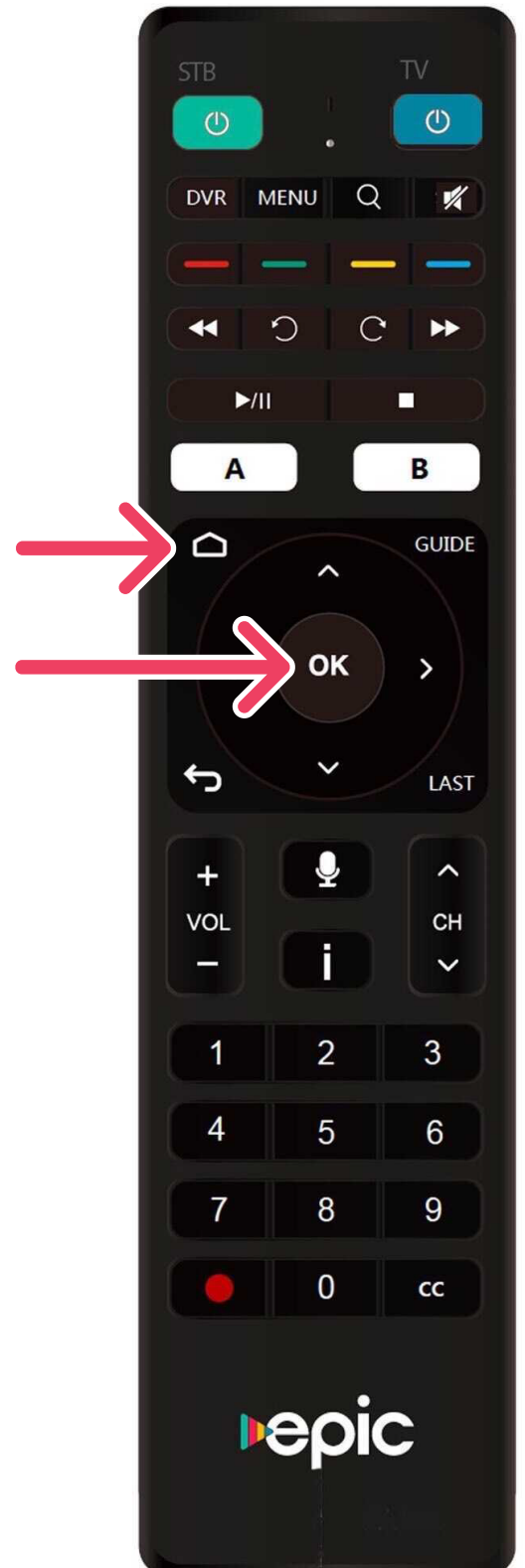

Instructions for pairing a remote control to your TV:

Access the device settings menu by pressing the 'Device Settings' gear in the top right corner of the login page, or go to the settings menu from the home page, press 'Device Settings' and select 'General'

Select 'Remotes & Accessories'

Select 'IR TV Setup' and follow the prompts

If pairing to your TV is successful, the 'Volume' button and 'TV Power' button should have functionality

To unpair your remote from your TV:

Press and hold the 'Red' and 'OK' buttons simultaneously for 3 seconds to unpair remote

or

Access the device settings menu

Navigate to 'Remotes and Accessories'

Select 'EPIC RCU' under devices

Select 'Unpair'

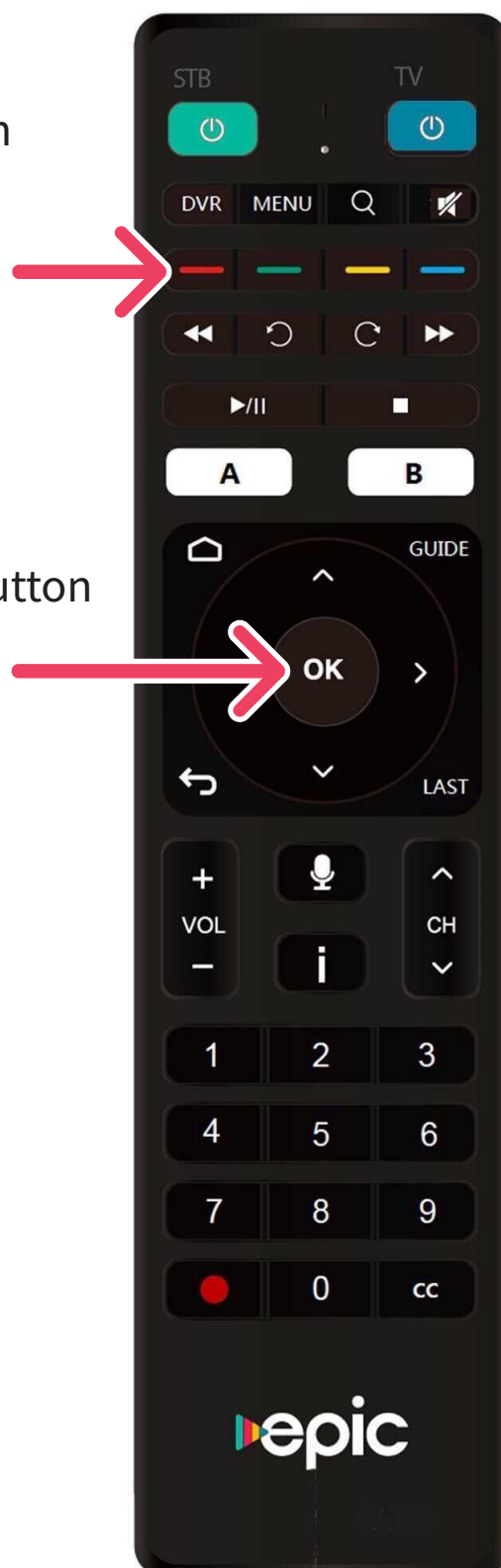



VIDEO TECHNOLOGIES

EPIC Remote Control User Guide

1 Set Top Box Power

2 Guide Search

3 Full Screen/Mini Screen

4 Guide Options

5 CDVR Fastforward/Rewind

6 Play/Pause

7 CDVR Skip Forward/Backward

8 Navigate

9 Back

10 Volume

11 Keypad

12 TV Power

13 Mute

14 Guide Next Day

15 Guide Previous Day

16 Stop

17 Guide Shortcut

18 Select

19 Previous Channel

20 Page Change/Channel Change

21 Guide Options and Info

22 Closed Captioning

